

Note:- any structural timber used to be treated against termites

Section (typical)

N.T.S

Detail			
Typical Section Brick Veneer Detail			
Drawn by	M.F	Date	2013
Checked		Date	

DIVERSEBUILDERS

P.O Box 196
 114 Melville Street
 Numurkah VIC 3636
 T 03 5862 2712
 F info@diversebuilders.com.au
 E @diversebuilders.com.au
 W diversebuilders.com.au



WARNING:-
 All information and designs contained within this document are copyright to Diverse Builders RBP Reg No. DBU-8259 - CBU-6016 & NSW 89500C

Construction Notes

general

All building work and construction is to comply with the relevant sections of the National Construction Code - Class 1 & Class 10 buildings

framing

-Timber Roof & wall framing to comply with A.S 1684.2 and to be treated against termites
-Steel roof & wall framing to comply with A.S 3623.1993& NCC part 3.4.2 Steel Framing

roofing

- Metal/sheet roofing to comply with manufacturers specification & A.S 1562.1
-Metal roof battens @ 450mm ctrs max to comply with Worksafe fall prevention requirements

plumbing

- all plumbing & drainage to comply with A.S/N.Z.S 3500

windows

- all windows & glazing to comply with A.S 1288 A.S 2047 & NCC - V2 - Part 3.6

masonry

- all masonry/brickwork to comply with A.S 3700 A.S 4773 & NCC - V2 - 3.3.1

waterproofing

- waterproof wet areas in accordance with NCC- V2 3.8.1 & to comply with A.S 3740

stairs/steps

-Construction of any stairways & balustrades shall comply with the requirements of the NCC- V2 - Part 3.9.1
- Riser 190mm max - 115mm min
- Going 355mm max - 240mm min
- Slope (2 x riser + going) 700mm max - 550mm min
- Threshold above external surface 190mm max

bushfire protection

- Bushfire prone area construction as per A.S 3959

termite control

- Termite protection as per A.S 3660.1 & in accordance with NCC - V2 - 3.1.3

insulation

Wall & Ceiling insulation refer to Energy Rating

damp proofing

Vapour barrier in accordance with AS 2870 NCC - V 2 Part 3.2.2.6 to prevent moisture reaching the upper surface of the floor. Damp proof course to AS/NZS 2904, AS3700 & AS 4773.1 & 2

<h1>Detail</h1>			
Construction Notes - Australian Standards			
Drawn by	M.F	Date	2013
Checked		Date	

DIVERSEBUILDERS

P.O Box 196
114 Melville Street
Numurkah VIC 3636
T 03 5862 2712
F info@diversebuilders.com.au
E @diversebuilders.com.au
W diversebuilders.com.au



WARNING:-

All information and designs contained within this document are copyright to Diverse Builders RBP Reg No. DBU-8259 - CBU-6016 & NSW 89500C

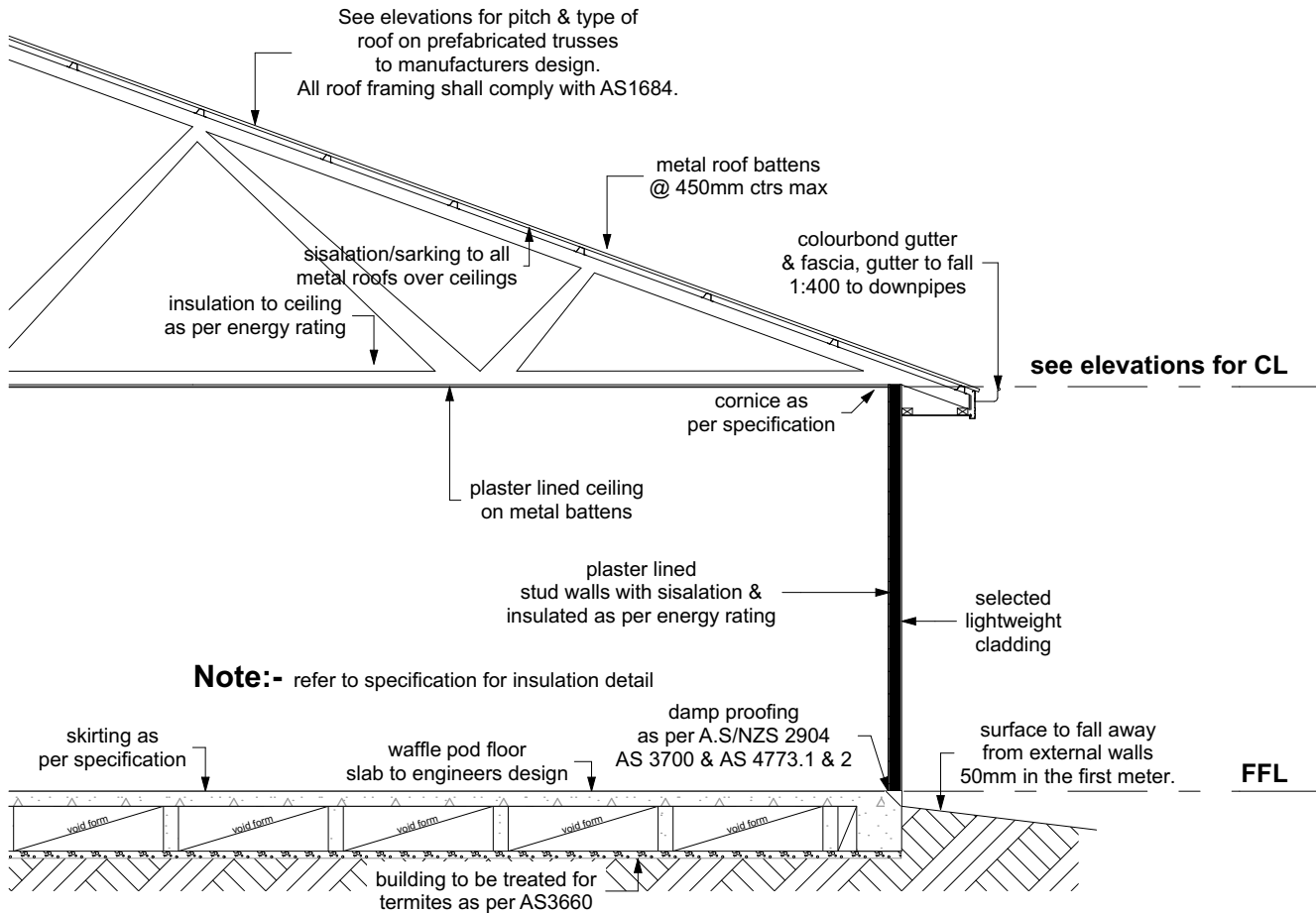

Note:- any structural timber used to be treated against termites

Section (typical)

N.T.S

Detail			
Typical Section Lightweight Cladding Detail			
Drawn by	M.F	Date	2013
Checked		Date	

DIVERSEBUILDERS

P.O Box 196
114 Melville Street
Numurkah VIC 3636
T 03 5862 2712
F info@diversebuilders.com.au
E @diversebuilders.com.au
W diversebuilders.com.au



WARNING:-
All information and designs contained within this document are copyright to Diverse Builders
RBP Reg No. DBU-8259 - CBU-6016 & NSW 89500C